

All dimensions to be checked on site. Figured dimensions take preference over scaled dimensions. Any errors or discrepancies to be reported to the Architects. This drawing may not be edited or modified by the recipient.

"Copyright and ownership of this drawing is vested in STRUTECH, whose prior written consent is required for its use, reproduction or for publication to any third party. All rights reserved by the law of copyright and by international copyright conventions are reserved to STRUTECH and may be protected by court proceedings for damages and/or injunctions and costs."

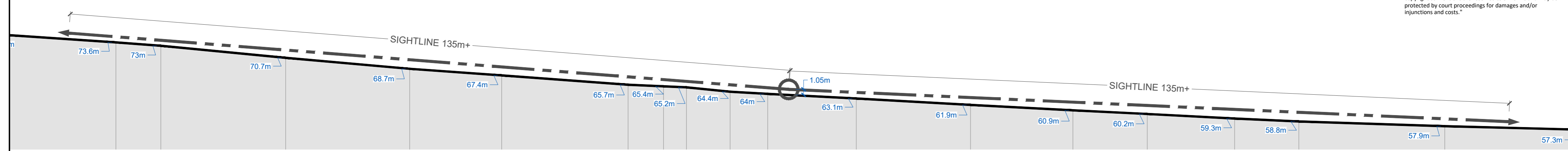

Proposed Sightlines - Road Section
SCALE 1:500
REFER TO SITE LAYOUT PLAN AND TRAFFIC REPORTS ALSO

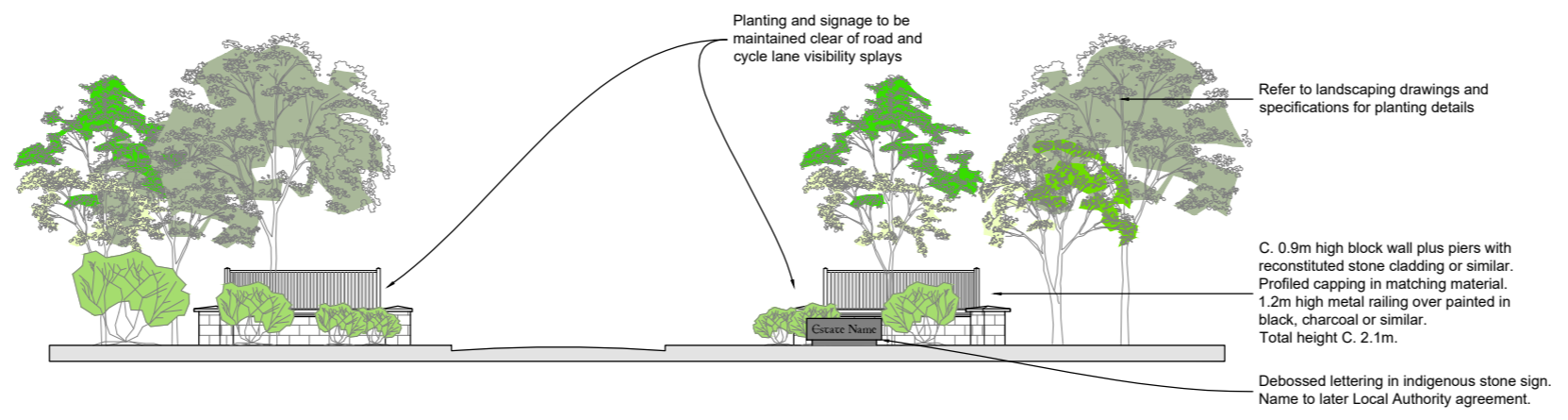
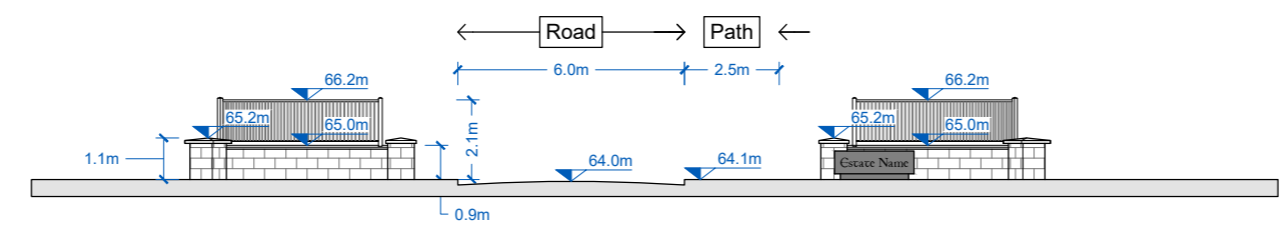

Proposed Road Elevation
SCALE 1:200

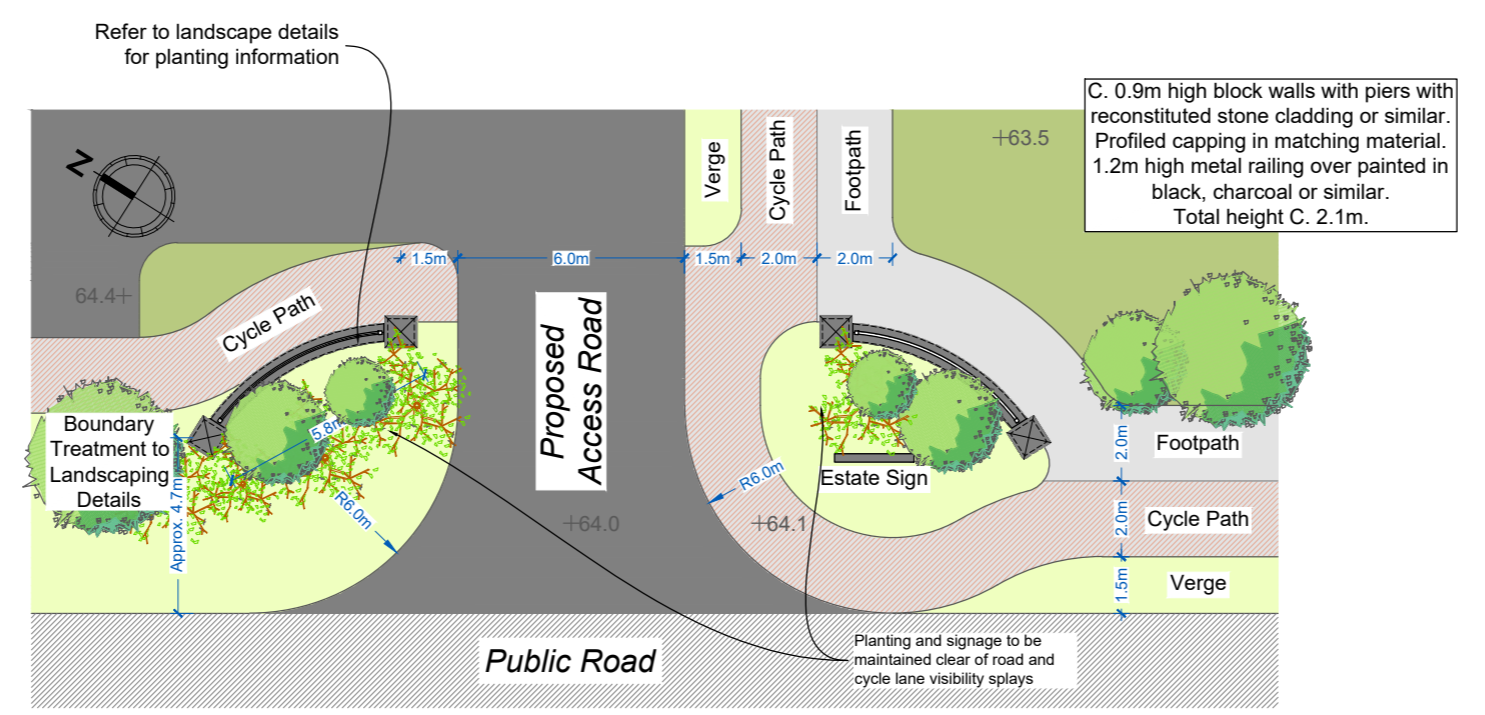

Proposed Plan
SCALE 1:200

REV	DATE	REV BY	DESCRIPTION
-	-	-	-
STATUS			
PLANNING			
PROJECT			
CREAGH STRATEGIC HOUSING RESIDENTIAL DEVELOPMENT			
PROJECT ADDRESS			
BALLOWEN/RAMSFORTPARK, GOREY, CO. WEXFORD			
DWG TITLE			
NORTH ENTRANCE DETAILS			
-			
DWG NO	PL2-030	REV	-
JOB NO	1725	SCALE @ A2	AS SHOWN
DATE	29.11.2018	DRN	Liam Minogue

STRUTECH
Architects - Engineers - Project Managers

STRUTECH, Architectural & Engineering Consultants, Garryhill, Bagenalstown, Co. Carlow, R2 KP44 Ireland
Tel +353 (0)59 97 27623
W www.strutec.ie
E info@strutec.ie